

Ball Tail and Tall Knob Set for Low-Angle Block Plane

05P22.05

Our ball tail and tall knob convert your Veritas® Low-Angle Block Plane into a small low-angle smoothing plane. To install the ball tail, skewing of the blade is required to gain access to the mounting screws. The ball tail then slips into place and is prevented from shifting due to small projections engaging in mating holes at the rear of the plane body.

Though the low-angle plane can be used with much force and comfort with only the ball tail, full benefit is obtained when you replace the brass front knob that came with your plane with the tall knob (05P22.04). The pair allows you to bear down quite heavily, acting as a small substitute for a traditional low-angle smoothing plane.

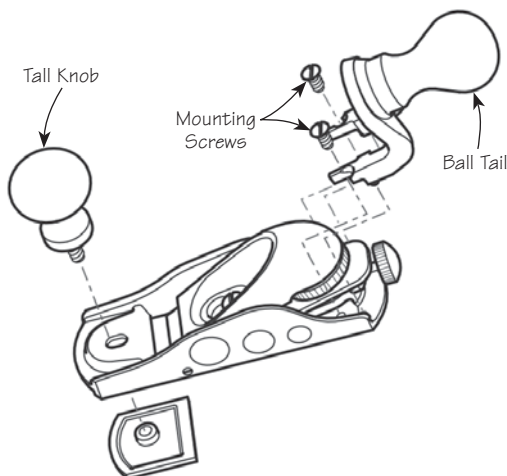

Figure 1: Ball tail and tall knob assembly.

Ball Tail Installation

Loosen the lever cap wheel and move the adjustment mechanism completely to one side. This moves the heel of the blade to the opposite side, fully exposing one of the threaded holes used for mounting the ball tail (as shown in **Figure 2**).

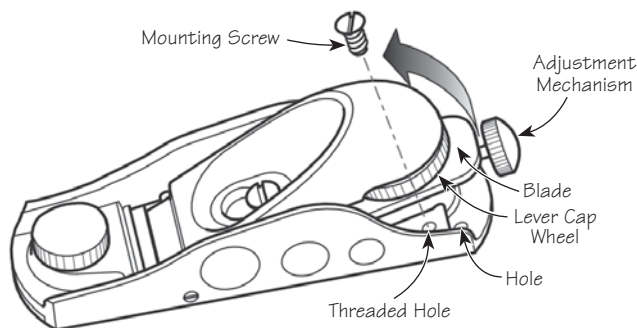

Figure 2: Heel of blade moved to expose threaded hole for mounting ball tail.

Install one of the mounting screws so that its top is just below the bottom of the blade as shown in **Figure 3**. Repeat for the second mounting screw, but move the adjustment mechanism in the opposite direction.

Slide the ball tail assembly (as shown in **Figure 3**) under the blade until both projections on the ball tail arm register in the rear holes in the block plane body. Firmly tighten both mounting screws, skewing the blade as required for access. Retighten the lever cap wheel after the lateral adjust has been reset as required.

If you wish to revert to using your block plane without the ball tail, reverse the procedure, but do not remove the mounting screws. They can be bottomed out in their holes, where they will safely remain and not loosen from vibration.

Tall Knob Installation

With the plane resting on a flat surface, unscrew the brass front knob and replace it with the tall knob as shown in **Figure 4**.

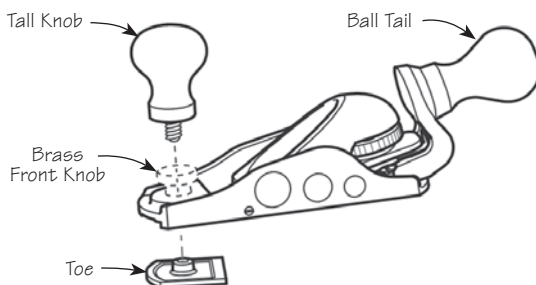

Figure 4: Installing the tall knob.